

Starting

Illustrated Index (Direct drive 0.8 kw ND)

CAUTION: Disconnect ground cable from battery post before removing starter.

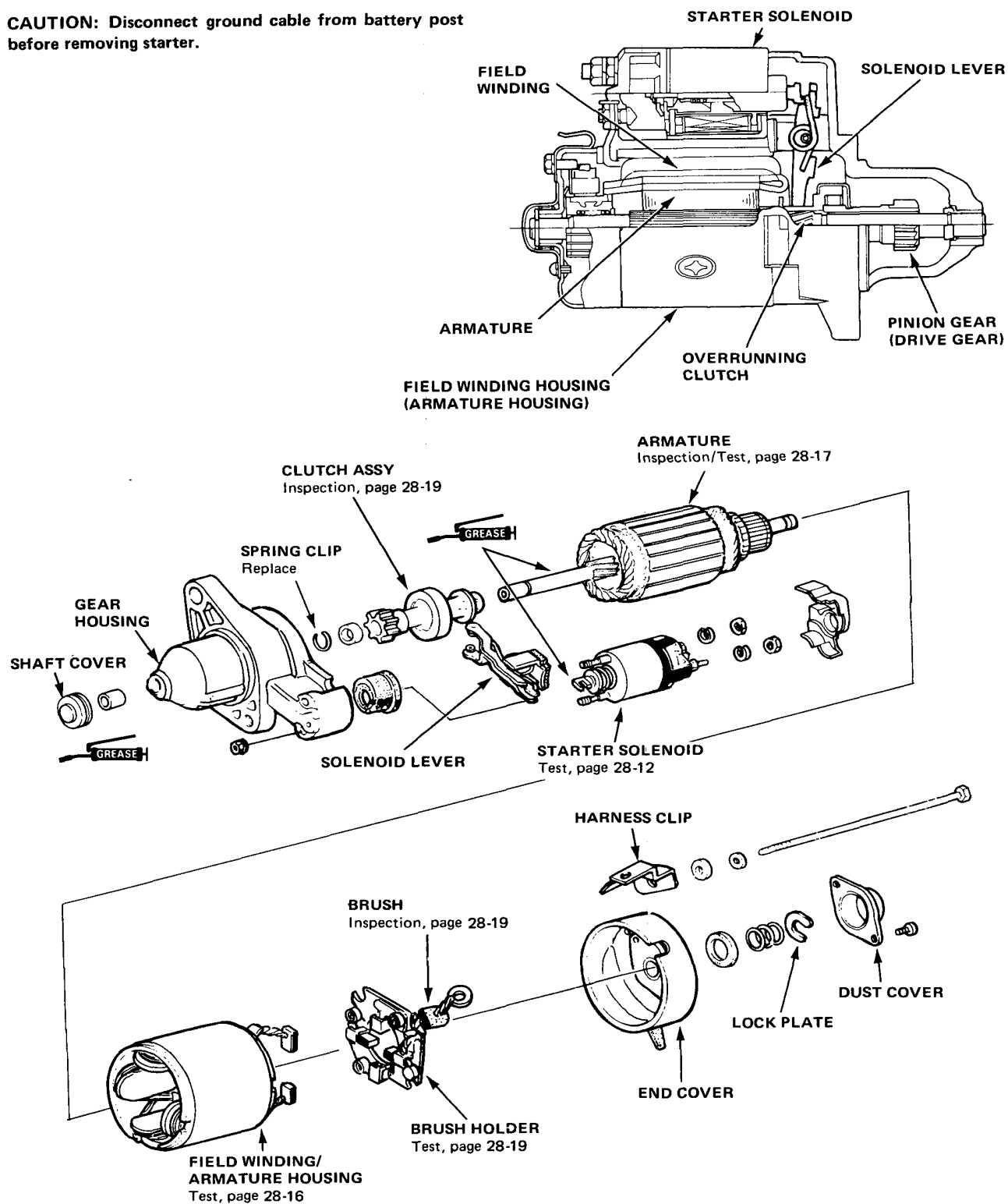



(Direct drive 0.8 kw HITACHI)

CAUTION: Disconnect ground cable from battery post before removing starter.

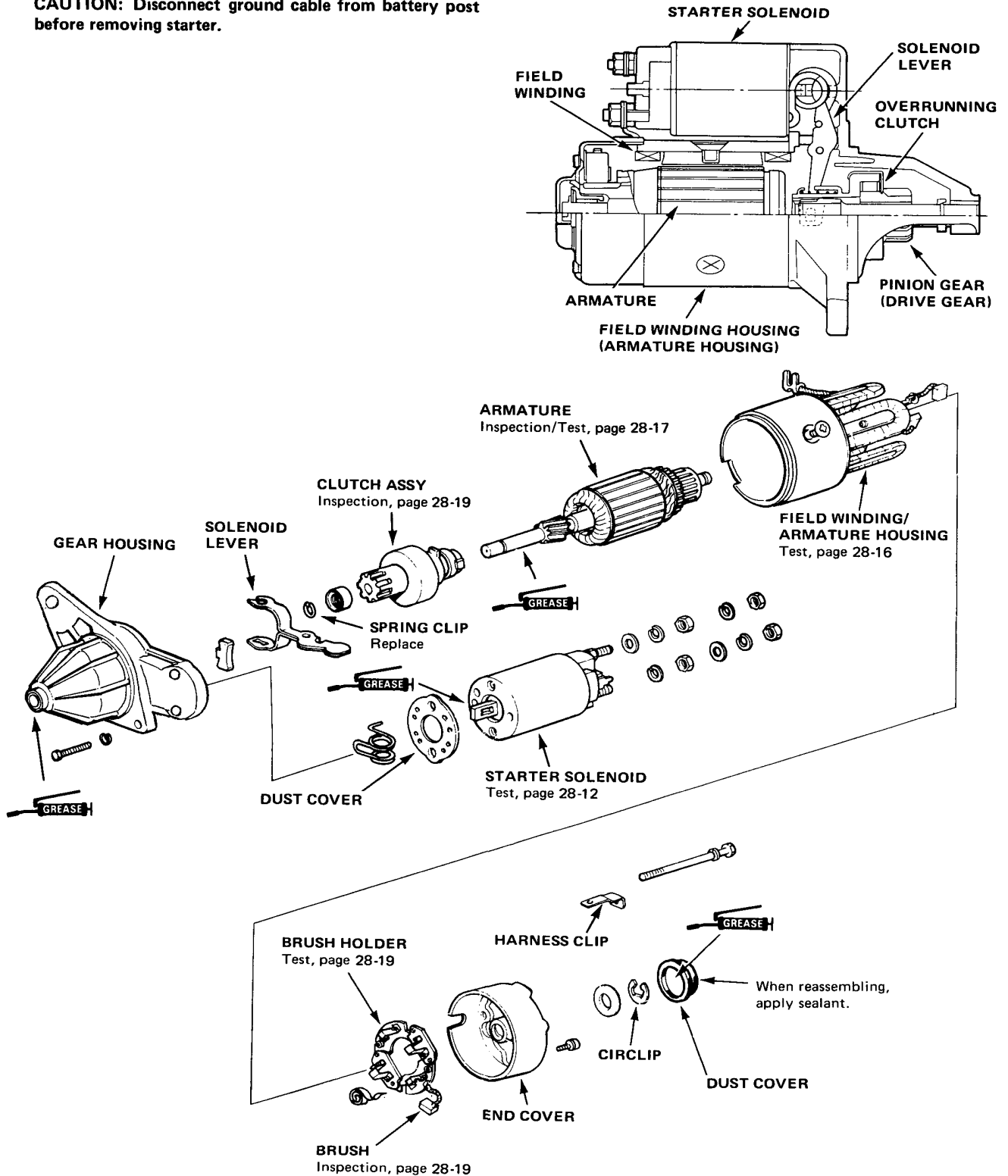

Starting

Illustrated Index (Gear reduction 1.0 kw ND)

CAUTION: Disconnect ground cable from battery post before removing starter.

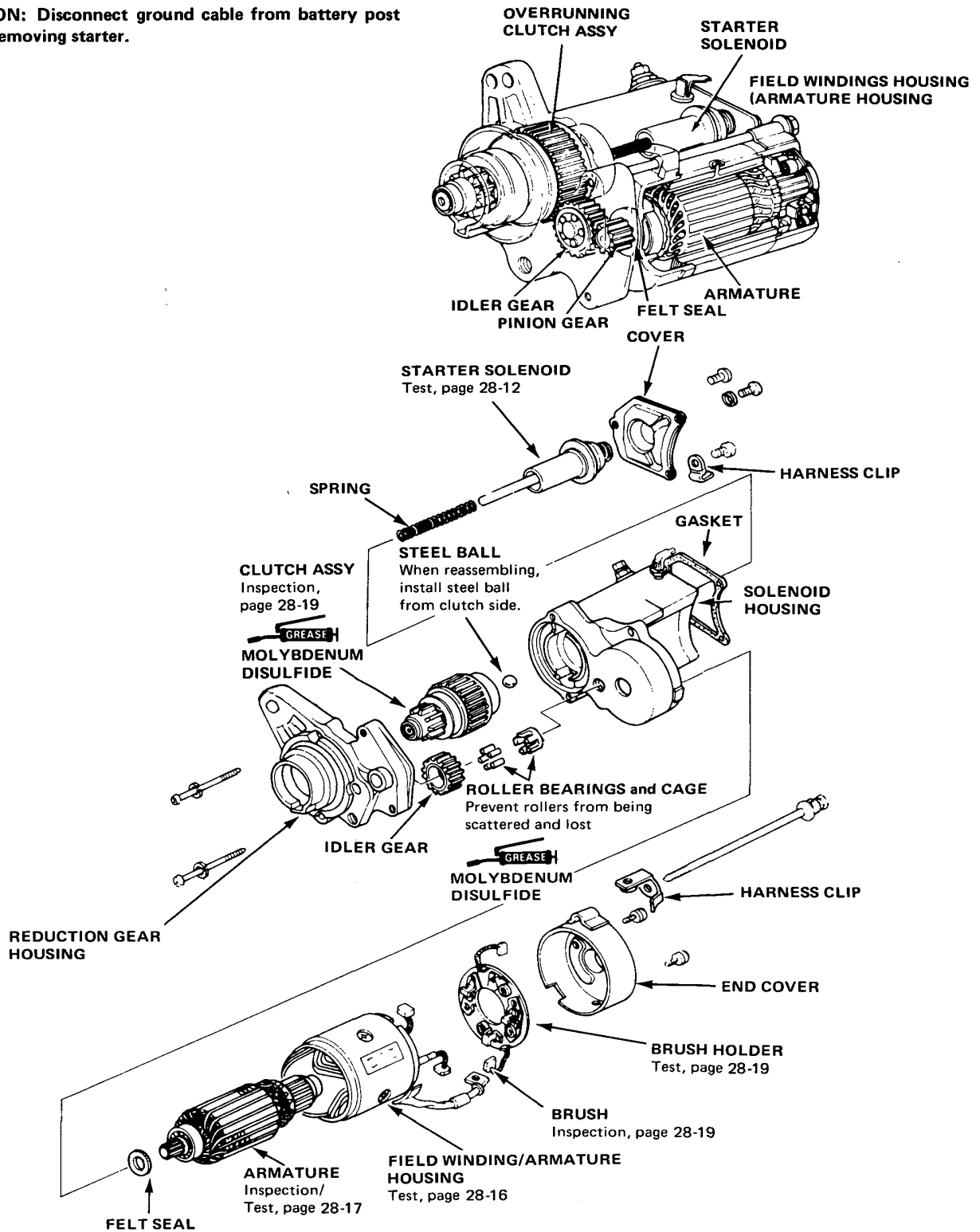



(Gear reduction 1.0 kw MITSUBA)

CAUTION: Disconnect ground cable from battery post before removing starter.

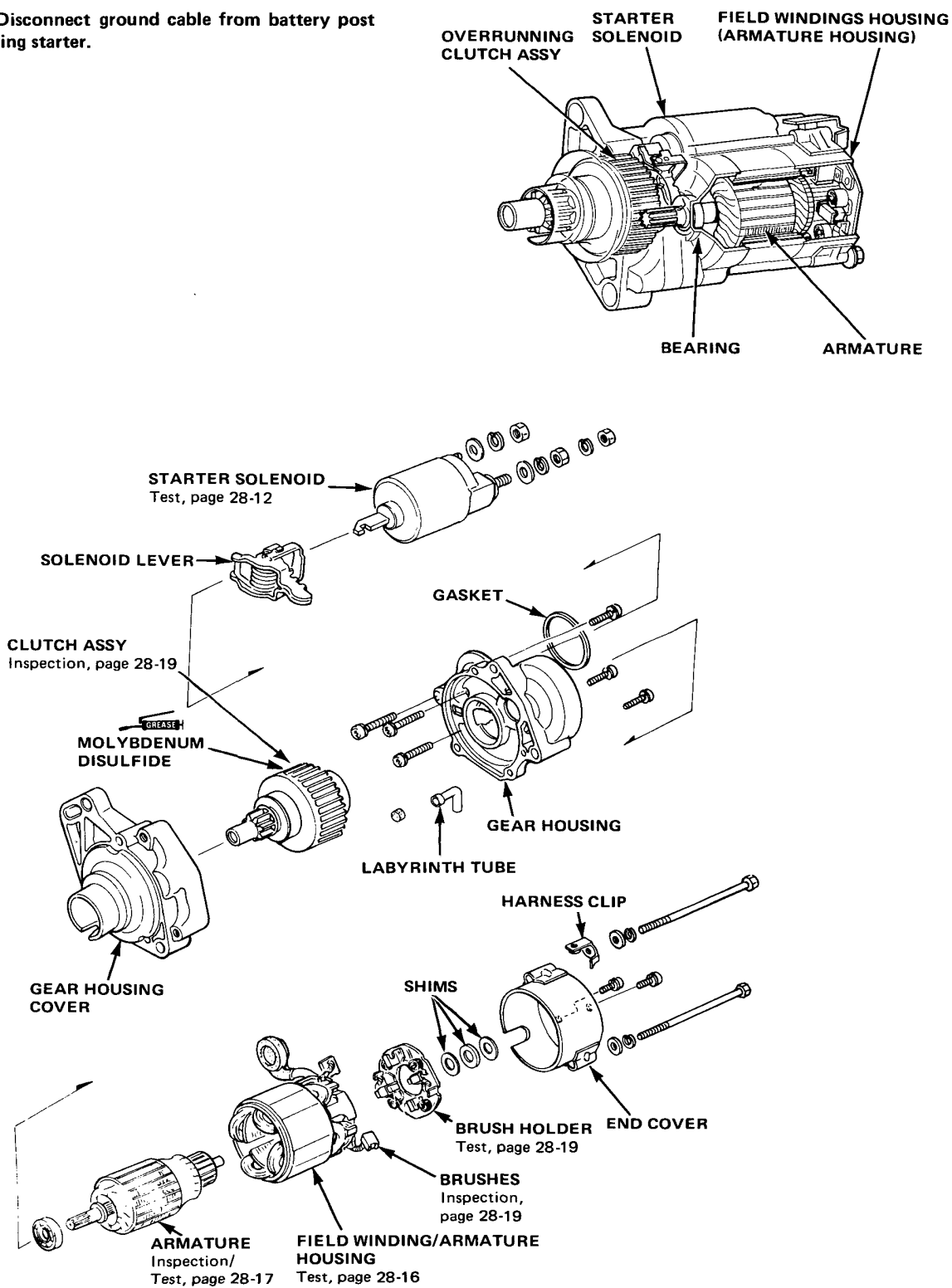

Starting

Illustrated Index (Gear reduction 1.4 kw ND)

CAUTION: Disconnect ground cable from battery post before removing starter.

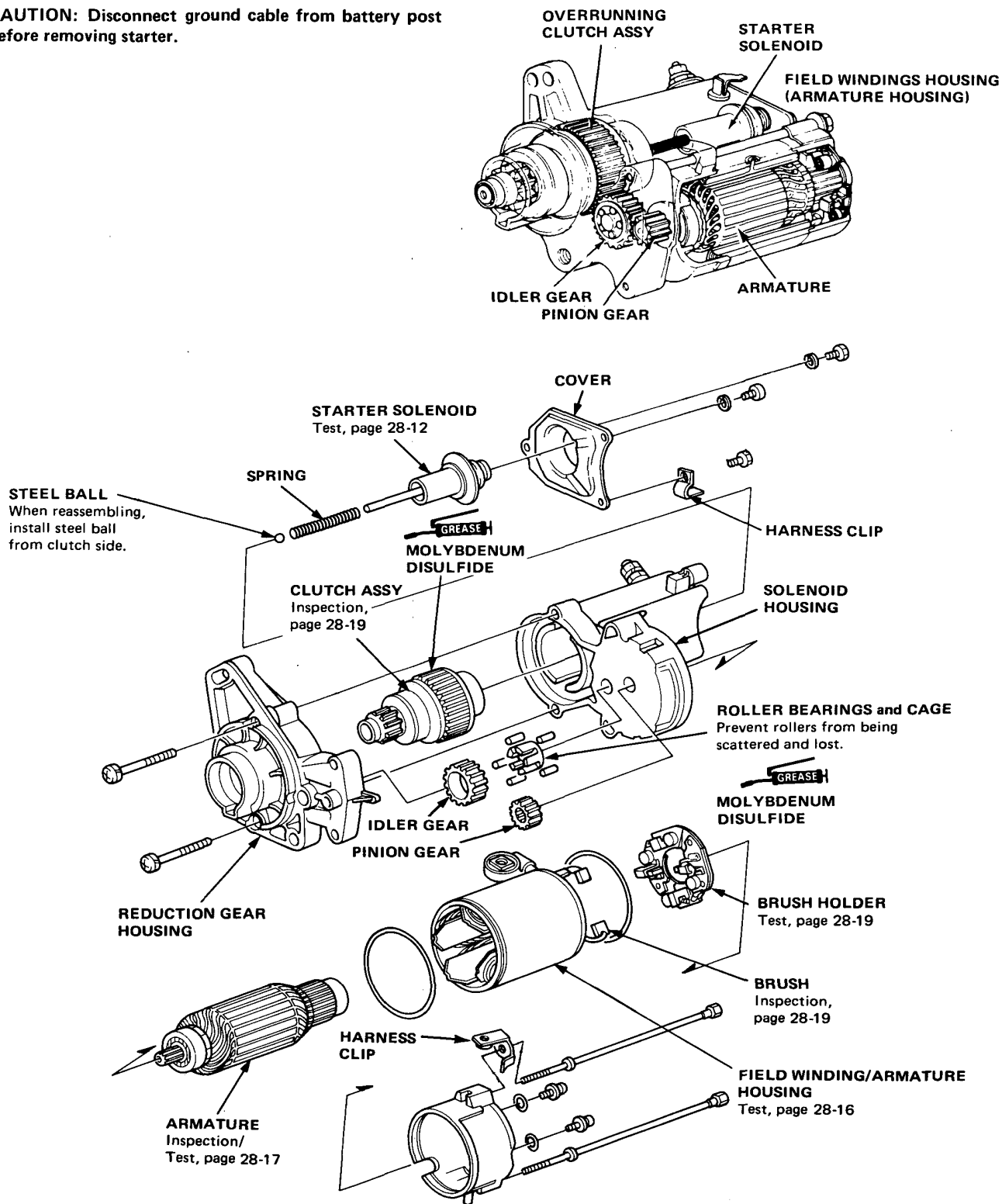



(Gear reduction 1.4 kw MITSUBA)

CAUTION: Disconnect ground cable from battery post before removing starter.

